



## 4 bed terraced house to buy in

Rothley Terrace, Medomsley, Consett,  
Durham, DH8 6PN

**£290,000** Offers Over

🏠 x4 🍽️ x2 🚿 x2

Tenure

**Freehold**

Off Street parking

Garden

## Property features

- ✓ Four bedroom stone built middle terrace house
- ✓ Property is allocated over three
- ✓ Lounge and dining room
- ✓ Two bathrooms
- ✓ EPC Rating D

## Key Information

- ✓ Council Tax: Band C
- ✓ EPC Rating: D
- ✓ Heating supply: Gas
- ✓ Electric supply: National Grid
- ✓ Water supply: Direct mains water
- ✓ Broadband: ADSL copper wire
- ✓ Mobile signal: Good

## Description

Presenting a beautifully structured four-bedroom terraced house in the tranquil village of Medomsley, Consett. This stone-built property stands as a testament to architectural excellence and has been carefully designed over three floors to maximize comfort and utility.

As you step inside, you're immediately welcomed by the first of two elegant reception rooms. This spacious area makes for the perfect setting for hosting guests or enjoying a restful day in. The second reception area serves as a formal dining room - a setup that ensures each meal is a grand event.

The gem of the property is undoubtedly its four bedrooms. Each one is generously sized and affords the occupiers the rest and relaxation they need. Comfortably accommodating a large family, this house ensures that each member has a place to call their own.

Further, the house is equipped with two well-appointed bathrooms where modern amenities meet classic style to provide a refreshing and efficient space.

The lounge area, with its welcoming charm and warm interiors, makes it a joy to spend quality time with loved ones or to simply unwind after a long day.

Embedded in the heart of Consett, the house is a stone's throw away from local amenities, offering a perfect blend of community living and access to nature.

If you are looking for a residential property that is both a house and a home, this middle terrace gem in Medomsley, Consett is your perfect answer. With its classic charm and modern comforts, it's more than a dwelling—it's a lifestyle.

The floorplan comprises Entrance porch, hallway, lounge, dining room and kitchen. To the first floor three bedrooms, bathroom and stairs to the second floor bathroom and bedroom. Further benefits include gas central heating, double glazed, town garden to the front rear patio garden with off road parking. open aspect countryside views to the front.

Council Tax Band: C

Tenure: Freehold

Price: Offers Over £290,000

Property Type: Terraced House

USPs: Garden, Chain free

Parking: Off Street

Year built: 1900

Construction materials: Stone built

Roofing type: Slate tiles

Risk of floods and or erosion: No

Flooded in last 5 years: No

Source of flood: Other

Flood defences: No

Planning permissions or proposals for development: No

Coalfield or mining area: No

Listed property: No

Conservation area: No

Public rights of way: No

Adaptions for accessibility: No

Restrictions: No

Required access: No

Heating: Gas

Electric: National Grid

Water: Direct mains water

Water meter: No

Sewerage: Standard UK domestic

Air conditioning: No

Broadband: ADSL copper wire

Mobile signal coverage: Good

## Entrance porch

Double glazed entrance door and front aspect window, courtesy light, tiled floor, partly tiled walls, further door into the hallway.

---

## Hallway

Stairs to the first floor landing, under stairs cupboard, feature radiator, wooden flooring.

---

## Lounge

4.50m x 3.70m (14'9" x 12'1")

Double glazed front aspect window, marble effect fireplace with tiled inset and hearth, coving to ceiling, ceiling rose, wooden flooring, feature radiator.



## Dining Room

3.90m x 3.90m (12'9" x 12'9")

Double glazed rear aspect window, marble effect fireplace with tiled hearth, coving to the ceiling, ceiling rose, wooden flooring, feature radiator.



## Kitchen

5.70m x 2.70m (18'8" x 8'10")

Fitted wall and base units incorporating counter work tops with a one and a half bowl sink unit, built in electric oven with extractor hood over, Integral microwave, washing machine and dish washer, down lighting, partly tiled walls, double glazed rear aspect door and windows, feature radiator.



## First floor landing

single radiator, stairs to the second floor.

---

## Bedroom One

3.70m x 3.50m (12'1" x 11'5")

Double glazed rear aspect window, double radiator, double radiator, built in cupboard.



## Bedroom Two

3.90m x 3.60m (12'9" x 11'9")

Double glazed front aspect window with open countryside views, double radiator.



## Bedroom Three

2.90m x 2.10m (9'6" x 6'10")

Double glazed front aspect window with open countryside views, double radiator.



## Bathroom

White three piece suite comprising centre bath, twin vanity wash hand basins, step in shower cubicle, low level w.c. heated towel rail, feature radiator, down lighting, double glazed rear aspect windows



## Second floor landing

single radiator, borrowed light window. doors into bathroom and bedroom.

## Bedroom Four

3.40m x 2.90m (11'1" x 9'6")

Double glazed front aspect dormer window with open countryside views, double radiator. Walk in wardrobe with single radiator, power points and lighting.



## Shower Room

White three piece suite comprising step in shower cubicle, pedestal wash hand basin, low level w.c. partly tiled walls, double radiator, storage into eaves, down lighting.



## **Front town garden**

Mainly paved with stone wall surrounding.

---

## **Rear patio garden**

mainly paved with fence and walled surrounding, double gates with off road parking, storage shed with double glazed door and external window.



Floor 0



Floor 1

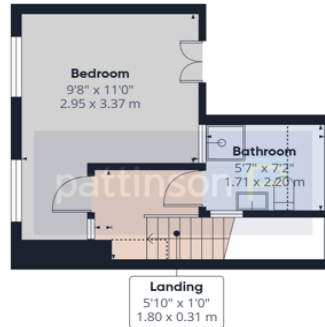

Floor 2

Approximate total area<sup>(1)</sup>  
1371 ft<sup>2</sup>  
127.4 m<sup>2</sup>

Reduced headroom  
14 ft<sup>2</sup>  
1.3 m<sup>2</sup>

(1) Excluding balconies and terraces

Reduced headroom  
..... Below 5 ft/1.5 m

Calculations reference the RICS IPMS 3C standard. Measurements are approximate and not to scale. This floor plan is intended for illustration only.

GIRAFFE360

Energy Efficiency Rating		
	Current	Potential
<i>Very energy efficient - lower running costs</i>		
(92-100) <b>A</b>		
(81-91) <b>B</b>		
(69-80) <b>C</b>		80
(55-68) <b>D</b>	56	
(39-54) <b>E</b>		
(21-38) <b>F</b>		
(1-20) <b>G</b>		
<i>Not energy efficient - higher running costs</i>		
<b>England, Scotland &amp; Wales</b>		EU Directive 2002/91/EC

Rothley Terrace, Medomsley, Consett, Durham, DH8 6PN

Contact your local branch today for more information on this property:

**79 Victoria Road East, Thornton-Cleveleys, Lancashire, FY5 5BU, [www.sea.co.uk/index.php](http://www.sea.co.uk/index.php)**

These particulars, whilst believed to be accurate are set out as a general outline only for guidance and do not constitute any part of an offer or contract. Intending purchasers should not rely on them as statements of representation of fact, but must satisfy themselves by inspection or otherwise as to their accuracy. No person in this firm's employment has the authority to make or give any representation or warranty in respect of the property.

