



### 3 bed end of terrace house to buy in TS19

Bransdale Close, Grangefield,  
Stockton-on-Tees, Durham, TS19 0SG

**£120,000**

🏠 x3 🚗 x1 🚲 x2

Tenure

**Freehold**

Driveway parking

### Property features

- ✓ Front, Rear and Side Gardens
- ✓ Modern Family Home
- ✓ Conservatory Overlooking The Rear Garden
- ✓ Close to Local Amenities and Transport Links
- ✓ EPC Rating E

## Key Information

- ✓ Council Tax: Band A
- ✓ EPC Rating: E
- ✓ Heating supply: Gas

## Description

Situated on the popular Bransdale Close in Grangefield, Stockton-on-Tees, this well-presented three-bedroom end of terrace property offers spacious and versatile accommodation, ideal for families and first-time buyers alike.

The home briefly comprises an entrance leading into a welcoming hallway, a bright and comfortable lounge, and a conservatory to the rear providing additional living space. The kitchen dining area creates a practical and sociable space perfect for everyday family life and entertaining. To the first floor are three good-sized bedrooms and a modern family bathroom. Externally, the property benefits from a driveway providing off-street parking, along with generous front, rear, and side gardens — offering excellent outdoor space.

Early viewing is highly recommended to fully appreciate the space and potential this home has to offer.

Council Tax Band: A

Tenure: Freehold

Price: £120,000

Property Type: End of terrace house

Parking: Driveway

Heating: Gas

## Entrance



## Lounge

5.14m x 3.13m (16'10" x 10'3")



## Kitchen/Dining Area

5.17m x 4.61m (16'11" x 15'1")



## Conservatory

3.20m x 2.57m (10'5" x 8'5")



## Stairs to First Floor

## Bedroom One

3.71m x 3.26m (12'2" x 10'8")



## Bedroom Two

3.28m x 3.12m (10'9" x 10'2")



## Bedroom Three

2.86m x 1.83m (9'4" x 6'0")



## Bathroom W/C

3.09m x 2.00m (10'1" x 6'6")



## External



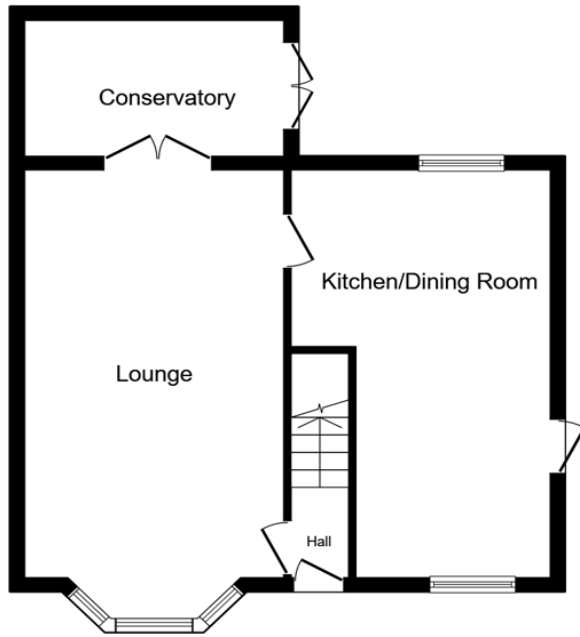

Ground Floor

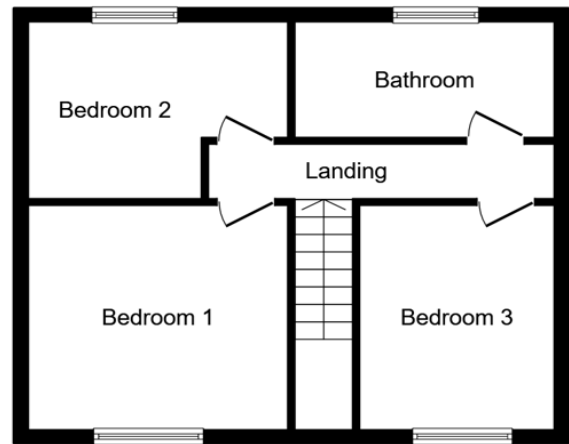

First Floor

This floor plan is for illustrative purposes only. It is not drawn to scale. Any measurements, floor areas (including any total floor area), openings and orientations are approximate. No details are guaranteed, they cannot be relied upon for any purpose and do not form any part of any agreement. No liability is taken for any error, omission or misstatement. A party must rely upon its own inspection(s). Powered by www.Propertybox.io

| Energy Efficiency Rating                           |                            |           |
|--|----------------------------|-----------|
|  | Current                    | Potential |
| <i>Very energy efficient - lower running costs</i> |                            |           |
| (92-100) <b>A</b>                                  |                            |           |
| (81-91) <b>B</b>                                   |                            |           |
| (69-80) <b>C</b>                                   |                            |           |
| (55-68) <b>D</b>                                   |                            | 67        |
| (39-54) <b>E</b>                                   | 53                         |           |
| (21-38) <b>F</b>                                   |                            |           |
| (1-20) <b>G</b>                                    |                            |           |
| <i>Not energy efficient - higher running costs</i> |                            |           |
| <b>England, Scotland &amp; Wales</b>               | EU Directive<br>2002/91/EC |           |

Bransdale Close, Grangefield, Stockton-on-Tees, Durham, TS19 0SG

Contact your local branch today for more information on this property:

**79 Victoria Road East, Thornton-Cleveleys, Lancashire, FY5 5BU, [www.seea.co.uk/index.php](http://www.seea.co.uk/index.php)**

These particulars, whilst believed to be accurate are set out as a general outline only for guidance and do not constitute any part of an offer or contract. Intending purchasers should not rely on them as statements of representation of fact, but must satisfy themselves by inspection or otherwise as to their accuracy. No person in this firm's employment has the authority to make or give any representation or warranty in respect of the property.

