



## 2 bed terraced house to buy in

Stanley Street, Norton, Stockton-on-Tees,  
Durham, TS20 1HG

**£110,000** Offers Over

🛏 x2 🚿 x1 🚻 x2

Tenure

**Freehold**

On Street parking

## Property features

✓ EPC Rating D

## Key Information

- ✓ Council Tax: Band A
- ✓ EPC Rating: D
- ✓ Heating supply: Gas

## Description

This two-bedroom mid-terrace property on Stanley Street, Norton offers an excellent opportunity for first-time buyers and investors alike. Ideally positioned within a popular residential area, the home provides convenient access to local amenities, schools and transport links.

The accommodation briefly comprises an entrance hallway leading into a comfortable lounge, flowing through to a separate dining area—perfect for both everyday living and entertaining. To the rear, the kitchen offers a practical space with access to the ground floor bathroom. To the first floor are two generously sized double bedrooms, providing ample space for a growing household or rental potential. Externally, the property benefits from a low-maintenance rear yard.

Early viewing is highly recommended to appreciate the potential this home has to offer.

Council Tax Band: A

Tenure: Freehold

Price: Offers Over £110,000

Property Type: Terraced House

Parking: On Street

Heating: Gas

## Entrance



## Hallway

## Lounge

3.31m x 3.25m (10'10" x 10'7")



## Dining Area

4.33m x 3.30m (14'2" x 10'9")



## Kitchen

4.65m x 1.95m (15'3" x 6'4")



## Bathroom W/C

2.10m x 1.73m (6'10" x 5'8")



## Stairs to First Floor

---

### Bedroom One

4.21m x 3.35m (13'9" x 10'11")



### Bedroom Two

3.30m x 3.65m (10'9" x 11'11")



### External



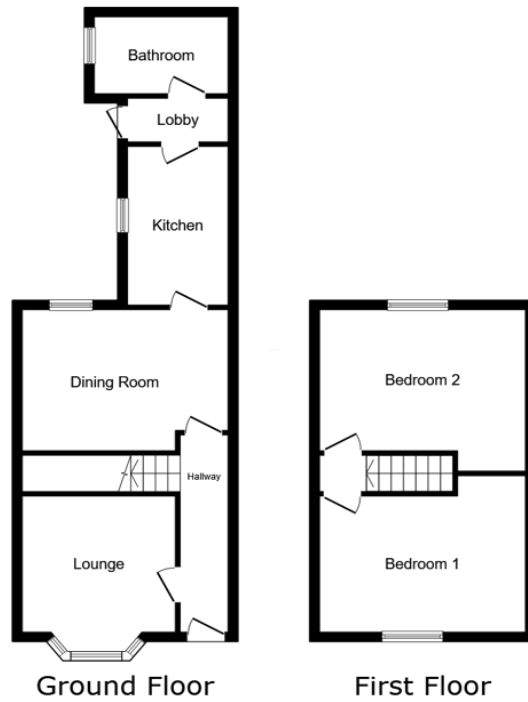

This floor plan is for illustrative purposes only. It is not drawn to scale. Any measurements, floor areas (including any total floor area), openings and orientations are approximate. No details are guaranteed, they cannot be relied upon for any purpose and do not form any part of any agreement. No liability is taken for any error, omission or misstatement. A party must rely upon its own inspection(s). Powered by [www.Propertybox.io](http://www.Propertybox.io)

| Energy Efficiency Rating                           |         |                         |
|--|---------|-------------------------|
|  | Current | Potential               |
| <i>Very energy efficient - lower running costs</i> |         |                         |
| (92-100) <b>A</b>                                  |         |                         |
| (81-91) <b>B</b>                                   |         | 81                      |
| (69-80) <b>C</b>                                   |         |                         |
| (55-68) <b>D</b>                                   | 62      |                         |
| (39-54) <b>E</b>                                   |         |                         |
| (21-38) <b>F</b>                                   |         |                         |
| (1-20) <b>G</b>                                    |         |                         |
| <i>Not energy efficient - higher running costs</i> |         |                         |
| <b>England, Scotland &amp; Wales</b>               |         | EU Directive 2002/91/EC |

Stanley Street, Norton, Stockton-on-Tees, Durham, TS20 1HG

Contact your local branch today for more information on this property:

**79 Victoria Road East, Thornton-Cleveleys, Lancashire, FY5 5BU, [www.seea.co.uk/index.php](http://www.seea.co.uk/index.php)**

These particulars, whilst believed to be accurate are set out as a general outline only for guidance and do not constitute any part of an offer or contract. Intending purchasers should not rely on them as statements of representation of fact, but must satisfy themselves by inspection or otherwise as to their accuracy. No person in this firm's employment has the authority to make or give any representation or warranty in respect of the property.

